

For Safety, remove cutting dies prior to mounting or rotating covers. Follow your company's safety procedures.

TOOLS



Use proper installation tools. Removal tool #F/CVR-REM-2, and dead blow mallet #MLT-RS4LB.

INSTALLATION

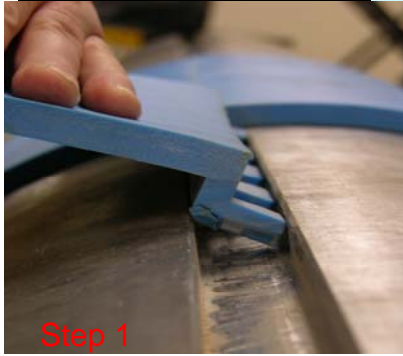

Always be sure that cylinder is clean and free of sharp edges or burrs. Be sure that Chamfer does not have sharp edge. Dull edge with hand file if needed.

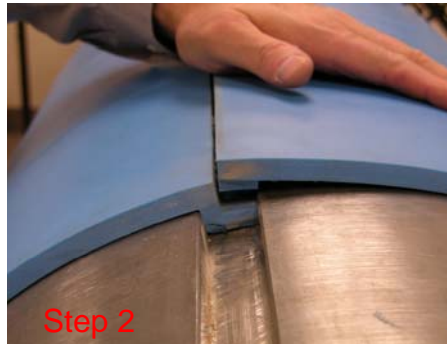

Step 2 Wrap the male end of the cover around the cylinder and align with the secured female end. Male can be compressed into female by hand.

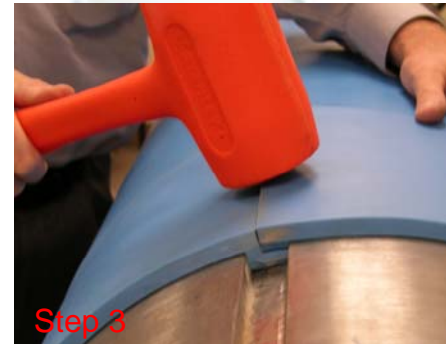

Step 3 Secure the male into the female by tapping with a dead blow mallet. Work across the cover face until completely seated. Continue process.

Step 1. The female end of the cover is the lead edge and should follow the direction of cylinder rotation. Insert the female end of the cover into the cylinder slot at a 45 degree angle, and compress in slot. Lightly tap with dead blow mallet to ensure that the female is compressed and seated in the slot.

CAUTION! Never remove covers behind the metal backing. Product damage will occur. Follow removal instructions only.

REMOVAL



Step 1. Using Dicar tool #F/CVR-REM-2, insert the tool beneath both the male and female sections of the lock. Tap with dead blow mallet to assist if needed.



Step 2. Work tool across the channel forcing both ends of the lock to disengage. **CAUTION!** Stand away from cover as it pops off to prevent injury.



Step 3. Continue process working across cylinder until all covers are removed.